

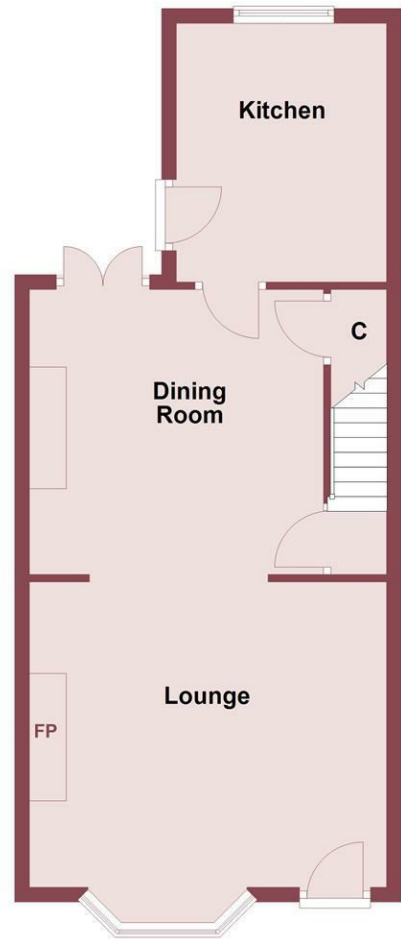

Ground Floor



First Floor



Gladstone Road, Neston, CH64 9PJ

Offers Over £195,000

 2 Bedroom  2 Reception  1 Bathroom 

No Onward Chain - Perfect First Time Buy or Investment Property - Attractively Priced Property Close To Neston Town Centre

Hewitt Adams are delighted to offer to the market a deceptively spacious, charming two double bedroom end terrace house on Gladstone Road. A stone's throw from Neston Town Centre and its excellent local amenities, fantastic schools and fabulous transport links. The property would make a fantastic first time buy or investment opportunity and would achieve in the region of £1000 per calendar month in rent. The property boasts very spacious accommodation and retains much of its character and charm.

The property also offers double glazing throughout and gas central heating.

In brief the property accommodation comprises; living room with open fire, kitchen, dining room, two double bedrooms and a spacious bathroom.

Externally, to the front of the property there is a small area leading to the front door, there is a paved courtyard to the rear with secure wall boundaries and gated access onto the shared entry.

This property would make a perfect first time buy or investment - please call Hewitt Adams to arrange your viewing.

Lounge

14'10 x 12'04 (4.52m x 3.76m)

Composite front door to lounge, bay window to front aspect, central heating radiator, open fire with feature surround, opening to dining area.

Kitchen

11'02 x 9'00 (3.40m x 2.74m)

Comprising a range of wall and base units with work surfaces incorporating sink and drainer, cooker, electric hob, space for fridge freezer, tiled splash back, tiled flooring, space and plumbing for washing machine and dishwasher, window to rear aspect, door to side.

Dining Room

12'11 x 11'10 (3.94m x 3.61m)

French doors to rear, central heating radiator, understairs storage cupboard, doors to;

Landing

Loft access hatch, inset spotlights, doors to;

Bedroom 1

14'09 x 12'03 (4.50m x 3.73m)

Bay window to front aspect, central heating radiator, traditional cast iron fireplace.

Bedroom 2

12'02 x 9'01 (3.71m x 2.77m)

Window to rear elevation, central heating radiator.

Bathroom

10'03 x 8'11 (3.12m x 2.72m)

A spacious bathroom comprising; WC, wash hand basin, bath, shower cubicle, radiator, two windows to side aspect, inset spotlights, boiler cupboard.

Additional information

Across from the courtyard there is a strip of land/ additional garden owned by our client which is available to purchase under separate negotiation - the agent can show this area on a viewing. Please note, this area is not incorporated into the current asking price.

